

Plastic Wafer Type Butterfly Valve Features

Adopting circular arrow mark, the pointer can indicate valve position accurately.
 Plastic outer shell has high performance of antiseptis
 Compact size suits for small equipment

Applications

Acid, alkali and other corrosive media
 Environmental protection, water supply and drainage, water treatment engineering
 HVAC
 Non-toxic plastic valve can be used in the food industry
 Particularly suitable for ClO₂, O₃ system

Certification: CE, ISO9001, MA, AL



200N normal on/off model



500N normal on/off model

200C Smart Plastic Wafer Type Butterfly Valve Main Components Diagram

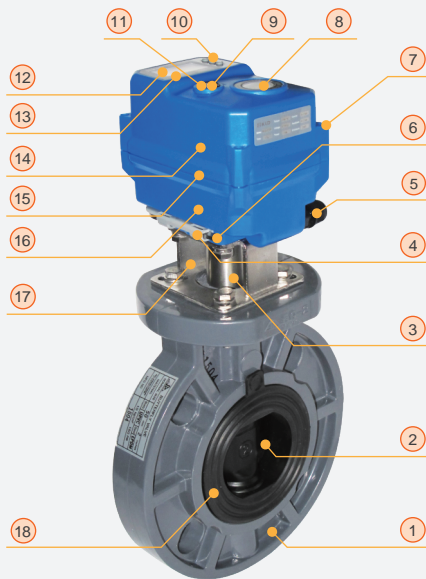

Main Components

No.	Parts	Material	Qty
1	Valve body	UPVC	1
2	Disc	UPVC	1
3	Coupling	304	1
4	Wrench fixed	Heatproof ABS	1
5	Cable connector	Nylon/Nickel-plated brass	1
6	Hexagon wrench	Tool steel	1
7	Screws	304	4
8	Indicator	Transparent AS	1
9	Manual shaft	304	1
10	Key	Rubber	3
11	Oil seal	NBR	1
12	Screen	OLED	1
13	Label	PVC	1
14	Top cover	Heatproof ABS/Casting aluminum	1
15	Lid seal	SI	1
16	Bottom cover	Heatproof ABS/Casting aluminum	1
17	Bracket	304	1
18	Disc seal	FPM	1

Normal on/off model no key and 1.3-inch OLED screen.

Dimension 【200C, DN50】

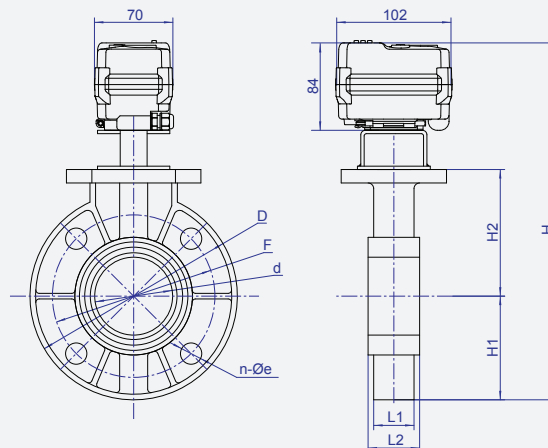

Connection Size (unit: mm)

DN	d	H1	H2	H	L1	L2	D	F	n-øe	W(Kg)
50	56.5	82.5	103	304.5	35	43	165	125	4-φ19	

Domestic Brands Wafer Type Butterfly Valve(Plastic) Main Size (unit: mm)

DN	d	H1	H2	H	F	n-øe	W(Kg)
50	54	79	87	285	123	4-φ20	

500C Smart Plastic Wafer Type Butterfly Valve Main Components Diagram

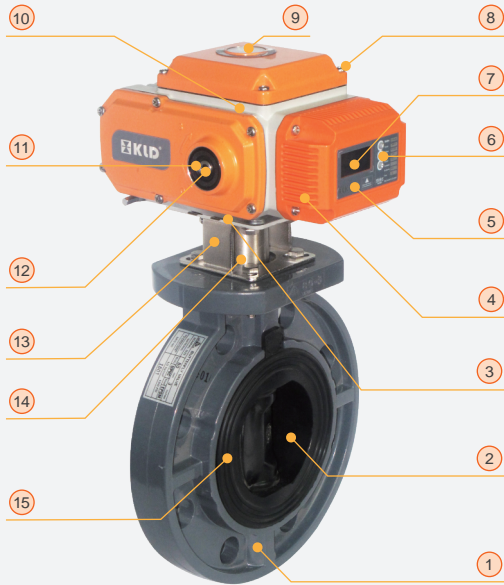

Main Components

No.	Parts	Material	Qty
1	Valve body	UPVC	1
2	Disc	UPVC	1
3	Hexagon wrench	Tool steel	1
4	Terminal block	Heatproof ABS	1
5	Label	PVC	1
6	Key	Rubber	3
7	Screen	OLED	1
8	Screws	304	17
9	Indicator	Tempered glass	1
10	Actuator	Casting aluminum	1
11	Oil seal	NBR	1
12	Manual shaft	304	1
13	Bracket	304	1
14	Coupling	304	1
15	Disc seal	FPM	1

Normal on/off model no key and 1.3-inch OLED screen.

Dimension 【500N, DN65/DN80】

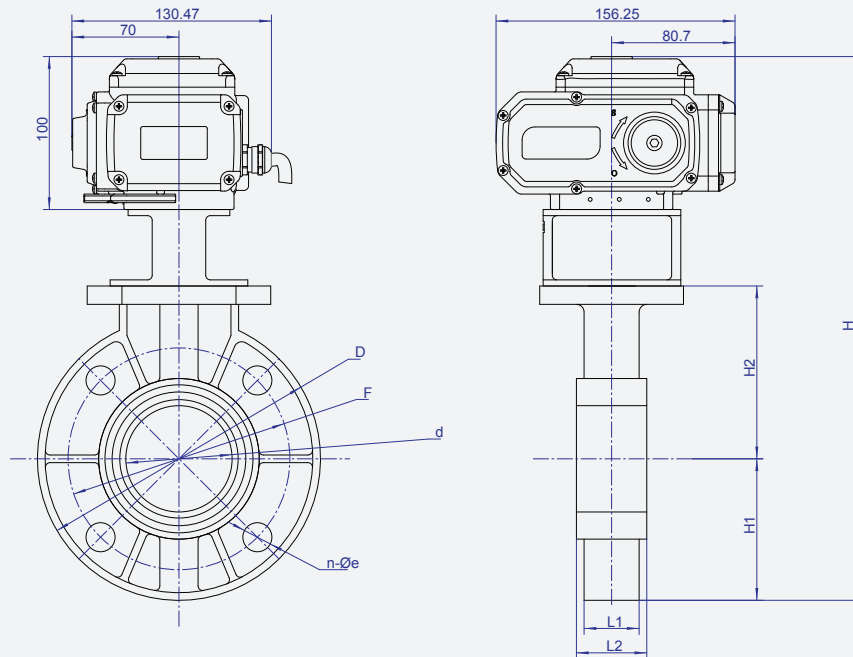

Connection Size (unit: mm)

DN	d	H1	H2	H	L1	L2	D	F	n-φe	W(Kg)
65	69.5	92.5	113	355.5	36	46	185	145	4-φ19	
80	79.5	100.0	115	365.0	36	46	201	160	8-φ18	

Domestic Brands Wafer Type Butterfly Valve (Plastic) Main Size (unit: mm)

DN	d	H1	H2	H	F	n-φe	W(Kg)
65	67	90	96	286	143	4-φ21	
80	83	96	114	310	157	4-φ21	

1000C Smart Plastic Wafer Type Butterfly Valve Main Components Diagram



Main Components

No.	Parts	Material	Qty
1	Valve body	UPVC	1
2	Disc	UPVC	1
3	Hexagon wrench	Tool steel	1
4	Terminal block	Heatproof ABS	1
5	Label	PVC	1
6	Key	Rubber	3
7	Screen	OLED	1
8	Screws	304	17
9	Indicator	Tempered glass	1
10	Actuator	Casting aluminum	1
11	Oil seal	NBR	1
12	Manual shaft	304	1
13	Disc seal	FPM	1

Normal on/off model no key and 1.3-inch OLED screen.

Dimension 【1000N, DN100/DN125】

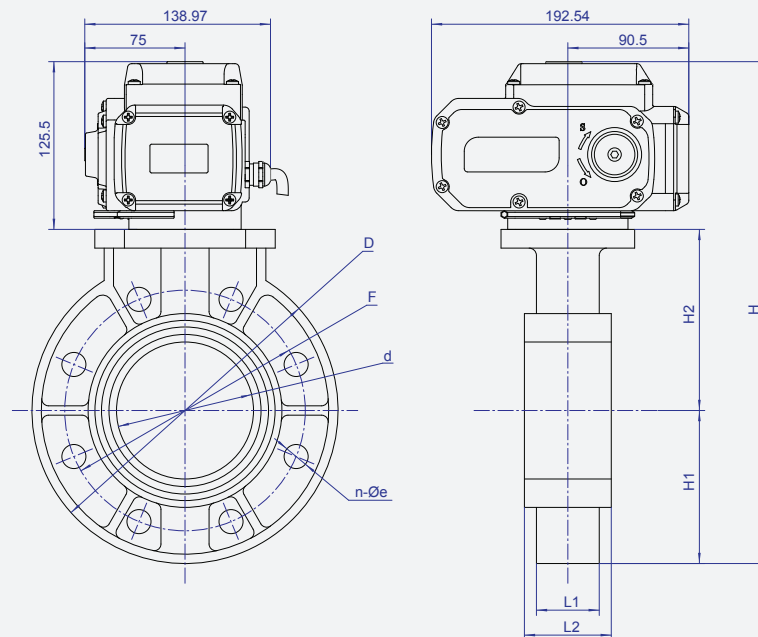

Connection Size (unit: mm)

DN	d	H1	H2	H	L1	L2	D	F	n-∅e	W(Kg)
100	102.5	30	135.5	291.0	47	65	229	180	8-∅18	
125	131.5	30	165.0	320.5	57	69	257	210	8-∅18	

Domestic Brands Wafer Type Butterfly Valve (Plastic) Main Size (unit: mm)

DN	d	H1	H2	H	F	n-∅e	W(Kg)
100	101	110	127	362.5	186	8-∅21	
125	127	127	157	409.5	213	8-∅24	

2000C Smart Plastic Wafer Type Butterfly Valve Main Components Diagram

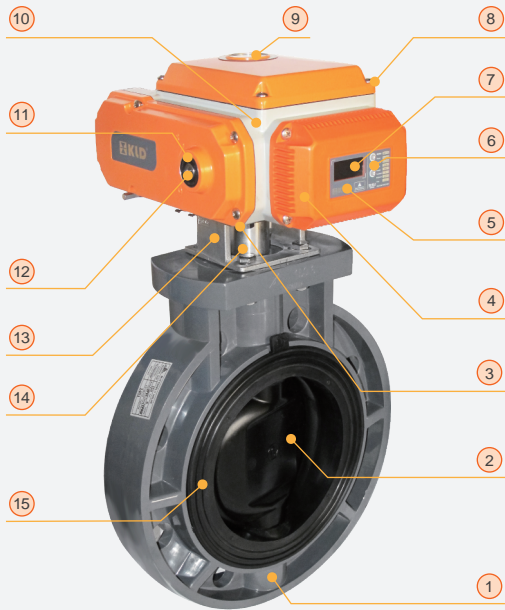

Main Components

No.	Parts	Material	Qty
1	Valve body	UPVC	1
2	Disc	UPVC	1
3	Hexagon wrench	Tool steel	1
4	Terminal block	Heatproof ABS	1
5	Label	PVC	1
6	Key	Rubber	3
7	Screen	OLED	1
8	Screws	304	17
9	Indicator	Tempered glass	1
10	Actuator	Casting aluminun	1
11	Oil seal	NBR	1
12	Manual shaft	304	1
13	Bracket	304	1
14	Coupling	304	1
15	Disc seal	FPM	1

Normal on/off model no key and 1.3-inch OLED screen.

Dimension 【2000N, DN150/DN200】

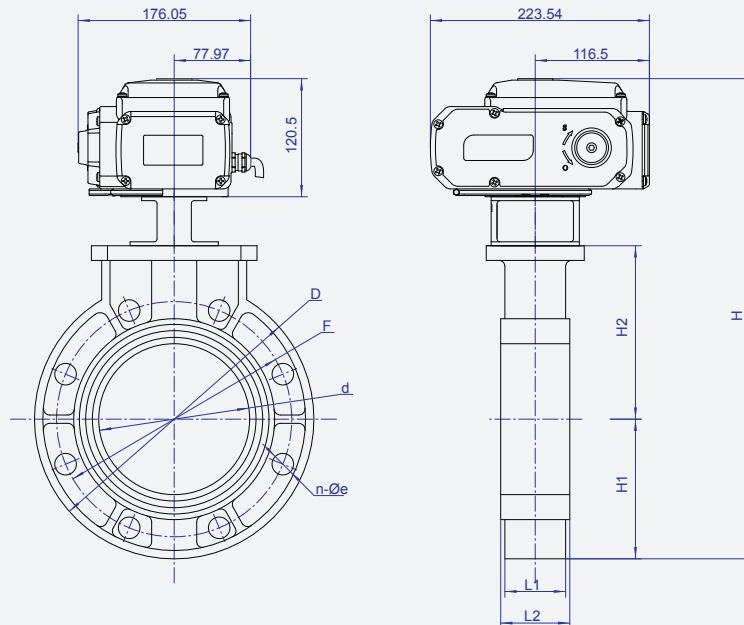

Connection Size (unit: mm)

DN	d	H1	H2	H	L1	L2	D	F	n-φe	W(Kg)
150	154	30	177	377.5	62	70.5	285	240	8-φ22	
200	203	39	210	419.5	76	87.0	343	295	8-φ23	

Domestic Brands Wafer Type Butterfly Valve (Plastic) Main Size (unit: mm)

DN	d	H1	H2	H	F	n-φe	W(Kg)
150	152	145	170	435.5	240	8-φ24	
200	200	172	213	505.5	296	8-φ24	

Electrical Parameters

Series type	Rated torque @rated voltage	Rated voltage	Available voltage range	Run/static power consumption @rated voltage	Peak crurent @rated volatage @5ms	External fuse specification	Running time ^{*1} (Per 90°)	Optional control mode
KLD-200N	15N.m	DC24V	DC22V-28V	36W/0.25W	1.5A	3A	10S@Power up 15S@Power down	KT32 or KT32S
		AC110V	AC90V-130V	40W/1.6W	90mA	1A		
		AC230V	AC190-250V	40W/1.6W	90mA	1A		
		DC12V	DC10-14V	3.5W/0.3W	1A	2A		
	20N.m	DC24V	DC22V-28V	15W/0.1W	1.2A	2A	15S	B3 BD3 B3S BD3S
		AC24V	AC18V-26V		0.5A	2A		
		AC110V	AC90V-130V		135mA	1A		
		AC230V	AC190-250V		60mA	1A		
KLD-500N	50N.m	DC24V	DC22V-28V	60W/1.5W	2.5A	5A	10S	B3S BD3S
		AC24V	AC22V-28V	50W/1W	3A	5A	20S	
		AC110V	AC90V-130V		1A	2A		
		AC230V	AC190-250V		0.5A	2A		
KLD-1000N	100N.m	DC24V	DC22V-28V		60W/1W	3.5A		5A
		AC24V	AC22V-28V	80W/1W	3.5A	5A	30S	
		AC110V	AC90V-130V		1.5A	3A		
		AC230V	AC190-250V		0.6A	2A		
KLD-2000N	200N.m	DC24V	DC22V-28V		180W/1W	4A		10A
		AC110V	AC90V-130V	150W/1W	2A	5A	30S	
		AC230V	AC190-250V		1A	5A		
KLD-4000N	400N.m	DC24V	DC22V-28V		240W/1W	5A		10A
		AC110V	AC90V-130V	200W/1W	2.5A	5A	30S	
		AC230V	AC190-250V		2A	5A		

* Since the running time is affected by the valve body, it is considered to be qualified within $\pm 3s$.

Function Parameters

The valve ball rotation Angel	90°
Protection grade	IP67 or F Type
Manual function	Standard (Manual override is only permitted to be used when power is cut)
Indicator	

Working Conditions

Ambient temperature	-20 ——60
Ambient humidity	Relative humidity \leq 85% ---- Suitable for IP67
	Relative humidity > 85% ---- Suitable for F Type
Medium temperature	0-45
Medium pressure	\leq 1.0MPa